

How can industry innovation meet the challenges of the CFP landing obligation?

@EDFOceans_EU / @Cystalseass118 / @EBCD_bxl

#GearingUp #CQT #LandingObligation #CFP

Gearing Up For Change



A collaborative approach for a responsive fishery

European Parliament, 8th December 2015

David Stevens
Skipper
Crystal Sea II

The Catch Quota Trial

Approached by the Marine Management Organisation in 2013.

Changes to fishing practices – more selective gear, on-board cameras and avoidance measures.

Built a collaborative approach – relationship with MMO and from 2014, Cefas, has been key.

Able to measure effectiveness to build confidence.

Only a few years – but trends and patterns emerging.

Not a one size fits all solution.



Real time data

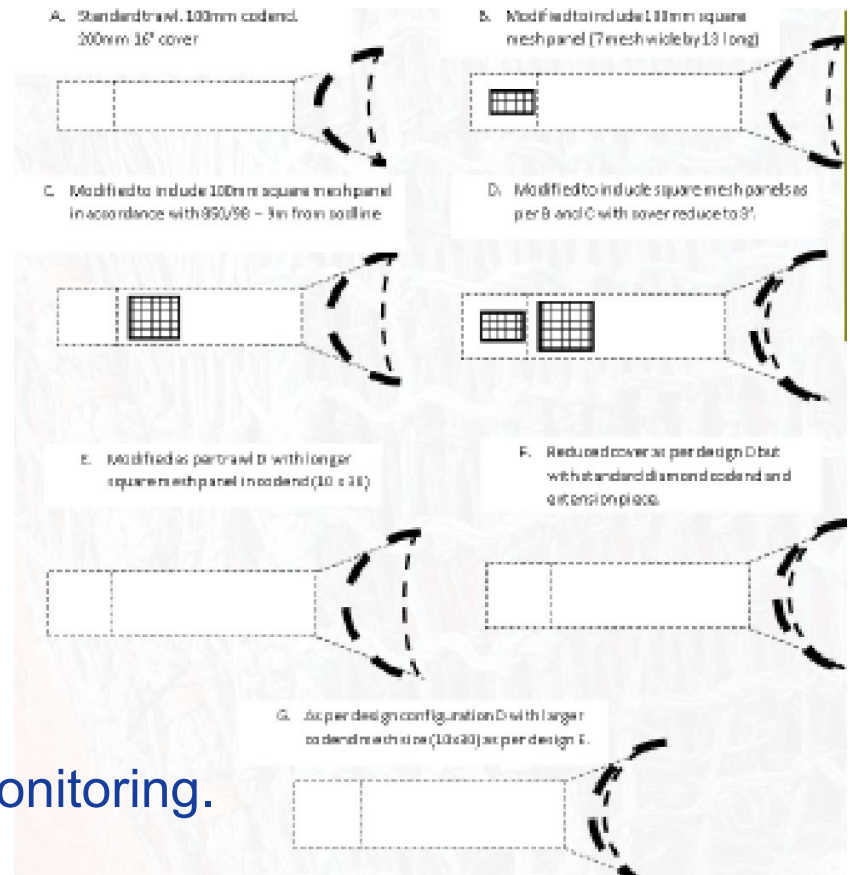

REM with e-logs allow for continuous monitoring.

Very comprehensive scientific data for low man power.

Helps build a clear picture of the best possible management solution.

Helps work out the realities of implementation of the landing obligation.

For fishery-wide impact, can consider having REM at a reference level.

Cameras: Friend or Foe?

With remote electronic monitoring (REM), catch is measured in **real time**.

Management gets real-time information— could be expanded to a **reference level** for the fleet.

If cameras are used to **empower fishermen** they can be a great friend.

However if only used as an **enforcement tool** they can feel like an obstacle to fishermen

Only beginning to scratch the surface of the value of cameras as a **scientific tool**.

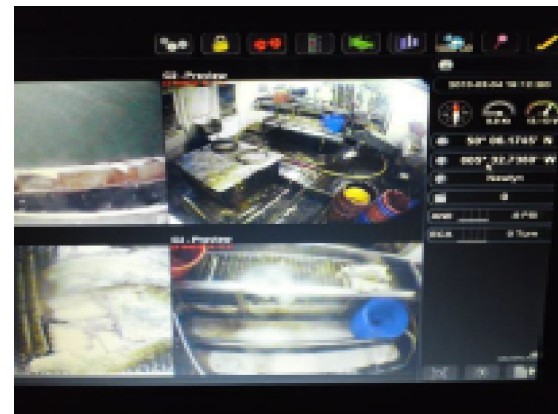

Incentives

Historically felt that role of fishermen in management was minimal with no opportunity to relay information back to policy-makers.

Opportunity to 'reverse the burden of proof' – get the industry more involved.

Empower fishermen through more self management of their fishery.

Help scientists and politicians create the right policy framework by getting involved in the management process.



(c) Laurence Hartwell

Economic impact



(c) Laurence Hartwell

Fishing more selectively carries a cost – catches overall are much lower. However, quality of catch is much higher and fetches a higher price

Financially, in the last few years the *Crystal Sea II* has had lower earnings due to reduced catch volumes, Because of the choking effect.

Many fishermen are likely to face large economic costs as a result of policy not matching the fishery.

We need a policy conversation about how this can be dealt with across Europe.

Final thoughts



Thank you!



How can industry innovation meet the challenges of the CFP landing obligation?

@EDFOceans_EU / @Cystalseass118 / @EBCD_bxl

#GearingUp #CQT #LandingObligation #CFP